

SIGNATURE

NORTH EAST

OFFICIALLY RATED THE NO.1 ESTATE AGENT IN THE NORTH EAST





Edith Street, North Shields NE30 2PN

Edith Street, North Shields NE30 2PN

Asking Price
£350,000

Signature North East welcomes you to this charming three-bedroom terraced home, ideally situated in the heart of Tynemouth, North Shields. Perfectly placed to enjoy everything this highly sought-after location has to offer, the property is within easy reach of the vibrant bars, restaurants, and cafés along Front Street, as well as beautiful green spaces and the stunning Longsands Beach and King Edwards Bay. For commuters and those exploring the wider region, Tynemouth Metro Station provides excellent transport links.

Upon entering, you are greeted by a welcoming hallway which provides access to the spacious living room. This inviting space boasts large windows that flood the room with natural light, a traditional fireplace adding charm and character, and ample room for your preferred furnishings. Flowing seamlessly from here is a versatile sitting room, providing further space to relax and unwind. The home's modern kitchen, refurbished this year, presents stylish wall and base units paired with sleek countertops. Generously sized to accommodate a dining set, the kitchen also benefits from integrated appliances including a fridge freezer and dishwasher, with direct access to the rear garden.

Ascending to the first floor, you will discover three well-proportioned bedrooms, two of which are comfortable doubles, offering excellent flexibility for families or those needing guest accommodation. The beautifully finished family bathroom, also updated this year, showcases both style and practicality, featuring a bathtub, walk-in shower, wash basin, and WC.

Externally, the property enjoys a private rear garden, an ideal space for relaxing or entertaining with outdoor furniture. On-street parking is readily available, adding to the convenience of this fantastic home.



PLEASE NOTE THAT THE VENDOR HAS CERTIFIED THE PROPERTY INFORMATION AND IMAGES.

PROPERTY FLOORPLAN

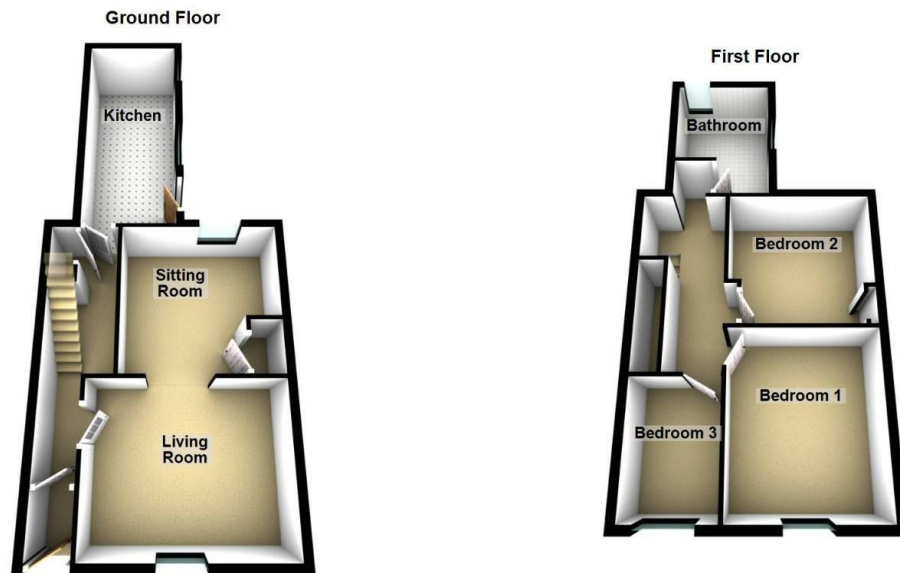

Total area: approx. 91.5 sq. metres (984.9 sq. feet)

Measurements:

Living Room
11'5" x 14'0"

Sitting Room
11'5" x 11'5"

Kitchen
17'9" x 7'5"

Bedroom One
12'7" x 10'9"

Bedroom Two
10'3" x 10'8"

Bedroom Three
9'1" x 6'3"

Bathroom
10'4" x 7'4"

Energy Efficiency Rating

	Current	Potential
Very energy efficient - lower running costs		
(92 plus) A		
(81-91) B		84
(69-80) C	70	
(55-68) D		
(39-54) E		
(21-38) F		
(1-20) G		
Not energy efficient - higher running costs		
England & Wales	EU Directive 2002/91/EC	





More 5 Star Customer Reviews than any other Agent based in the North East on [allAgents.co.uk](https://allagents.co.uk)



SALES

LETTINGS

FINANCE

LAW

WE COVER THE WHOLE OF THE NORTH EAST

Whitley Bay
0191 251 3344

Cramlington
01670 897 213

Tynemouth
0191 296 6689

Morpeth
01670 513 966

Ponteland
01661 820 082

Wallsend
0191 432 4151

Alnwick
01665 511 800

Heaton
0191 432 4275

Forest Hall
0191 266 9966

Other locations
0191 640 3523

Newcastle
0191 640 2284

Durham
0191 303 8252

Gosforth
0191 640 3523

Sunderland
0191 543 6390

Whickham
0191 432 5102

Gateshead
0191 432 4294

Jesmond
0191 281 1037

Killingworth
0191 640 3602

Ryton
0191 413 9845

Head Office &
Lettings
0191 253 4815

*Highest recommended 5-star reviews than any other Estate Agent based in the North East on [allAgents.co.uk](https://allagents.co.uk) - The UK's Largest Customer Review Website for the Property Industry & Awarded Best Estate Agency 2018 & 2019 - North East England by SME News